



# Data Sheet ST-950-E1 - Rev.0



APPROVED  
UL/FM approvals for model RD060  
on behalf of Rapidrop Global Ltd.

Assessed to ISO 9001:2008  
LPCB ref. 556d/01/03

G417009, G417010

## K80 (K5.6) Horizontal Sidewall Sprinklers Models: 950 (RD060) Standard Response 15mm (1/2" NPT)

### Product Description

Bocciolone Antincendio art. 950 are Standard Response frangible glass bulb automatic sprinklers. They are CE Marked, LPCB, VdS, FM approved, UL listed, standard orifice fire sprinklers for installation in fire sprinkler systems. In a fire condition the heat causes the fluid in the glass bulb to expand which shatters the glass and releases the spring seal assembly. Water flows from the orifice onto the sprinkler deflector which diffuses the water into a uniform spray pattern in order to control the fire.

Sidewall Sprinklers are designed for installation along a wall or side of a beam beneath a smooth ceiling.

### Models

- art.950 (RD060): Standard Response

### Standard Finishes

- Plain (Brass)
- Other finishes, available on request.

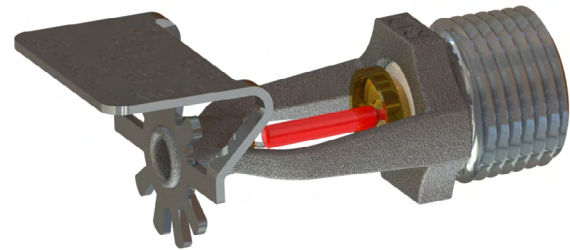

### Accessories

- Escutcheon
- Sprinkler Wrench

### Ordering Information

Specify: model, orifice size, operating temperature, response type, finish and approval listing required.

### Operating Temperatures

Nominal Operating Temperature	Bulb Colour
57°C (135°F)	Orange
68°C (155°F)	Red
79°C (175°F)	Yellow
93°C (200°F)	Green
141°C (286°F)	Blue

### Technical Details

K factor	K80 (K5.6)
Thread size	1/2" NPT
Max. Working Pressure	12 bar (175 psi)
Min. Operating Pressure	0.5 bar (7psi)
Factory Pressure Test	34 bar (500 psi)
Weight	60.6 g
Fitted with Bulb Protector	Remove after installing sprinkler
Top of Deflector to ceiling Distance (UL)	4 to 12 inches 100mm to 300mm

ST-950-E1  
Rev. 0  
21/04/20

BOCCIOLONE ANTINCENDIO S.P.A.  
T: +39 0163 568811 FAX: +39 0163 322022  
e-mail: info@bocciolone.com  
www.bocciolone.com



# Data Sheet ST-950-E1 - Rev.0



UL/FM approvals for model RD060  
on behalf of Rapidrop Global Ltd.

Assessed to ISO 9001:2008  
LPCB ref. 5569/01/03

G417009, G417010

## K80 (K5.6) Horizontal Sidewall Sprinklers Models: 950 (RD060) Standard Response 15mm (1/2" NPT)

### Design Coverage

For sprinkler coverage area and placement refer to NFPA 13, EN12845 or CEA4001 standards or other Installation rules for automatic sprinkler systems as required by the authority having jurisdiction. The following details are provided for information only.

### Installation

RD060 & RD061 Sprinklers are designed to be installed only in the horizontal position with the deflector parallel to the ceiling. The engraved word TOP on the deflector must be facing towards the ceiling.

1. All Bocciolone sprinklers must be installed and maintained in compliance with this document and according to the installation standards, or local rules and requirements which are specified by the authority having jurisdiction. It is the installer's responsibility to conform to such standards and requirements, deviations from the requirements will void any warranty.
2. To ensure that the minimum flow requirement is met, the system piping must be correctly sized.
3. To avoid mechanical damage the sprinklers must be installed after the piping is in place. Any damaged sprinklers must be replaced. If there is a leak from the sprinkler thread, remove the sprinkler, apply new pipe joint compound or tape and re-install.
4. Always check that the sprinklers are the correct model, style, orifice size, temperature and sensitivity ratings prior to commencing installation.
5. Use only non-hardening pipe joint compound or PTFE tape. Apply to external threads only.
6. Hand tighten the sprinkler into the fitting, then use the correct sprinkler wrench to tighten the sprinkler into the fitting. Ensure that the sprinkler wrench stays on the wrench flats while tightening the sprinkler. A leak tight joint requires only 10 to 19 Nm (7 to 14 ft.lbs.) torque. i.e. a tangential force of 6.35 to 12.7kgs. (14 to 28 lbs.) delivered through a 150mm (6") handle will deliver adequate torque. Torque levels over 29 Nm (21 ft.lbs.) may distort the orifice seal and result in a leakage.
7. Remove sprinkler bulb protector after the sprinkler is installed and before the system is put into service.

### Care and Maintenance

Sprinklers must be carefully handled and stored where temperatures will not exceed 100°F/38°C and they must never be painted, plated, coated or otherwise modified after leaving the factory.

Do not install sprinklers which have been dropped or damaged in any way. The installation rules required by the authority having jurisdiction contain guidelines on minimum inspection and maintenance requirements to assist owners fulfilling their responsibility to ensure sprinklers and sprinkler systems are maintained in proper operating condition.

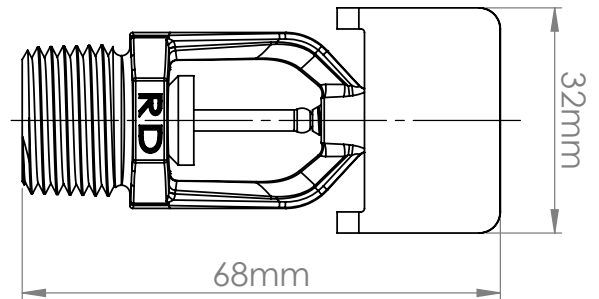
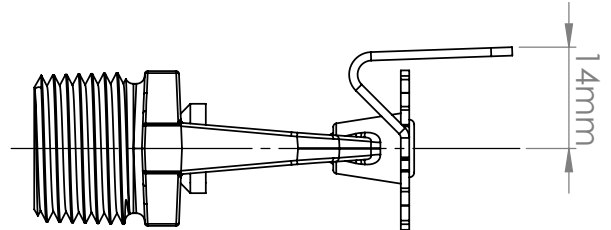

### Bocciolone K80 (K5.6) Sprinkler Flow Characteristics

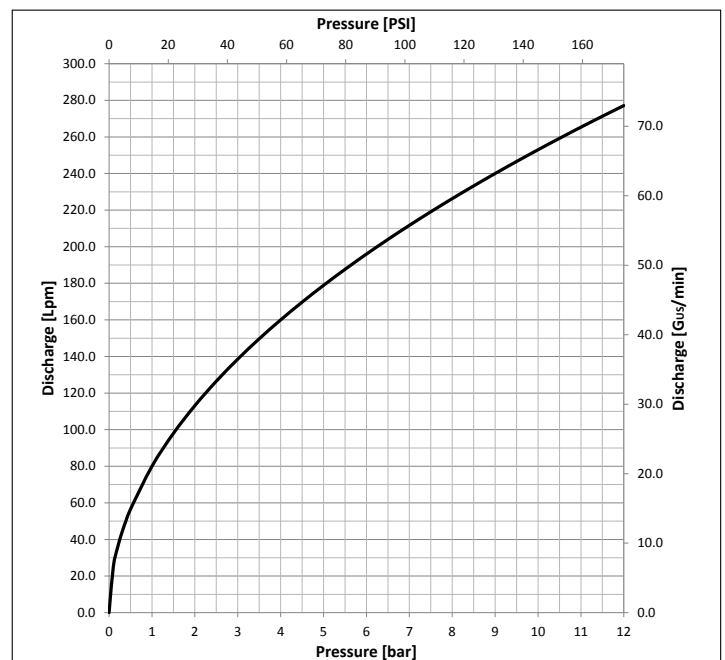

ST-950-E1  
Rev. 0  
21/04/20

BOCCIOLONE ANTINCENDIO S.P.A.  
T: +39 0163 568811 FAX: +39 0163 322022  
e-mail: info@bocciolone.com  
www.bocciolone.com



# Data Sheet ST-950-E1 - Rev.0



UL/FM approvals for model RD060  
on behalf of Rapidrop Global Ltd.

Assessed to ISO 9001:2008  
LPCB ref. 5569/01/03

G417009, G417010

## K80 (K5.6) Horizontal Sidewall Sprinklers Models: 950 (RD060) Standard Response 15mm (1/2" NPT)

### Spray Patterns

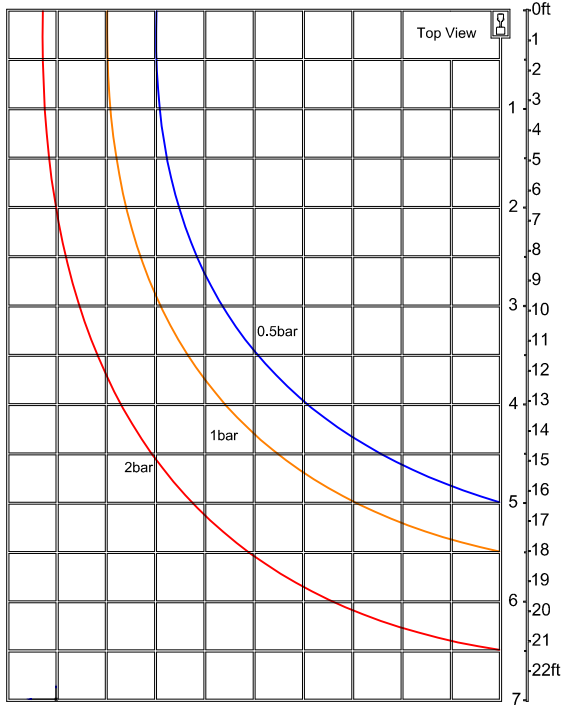
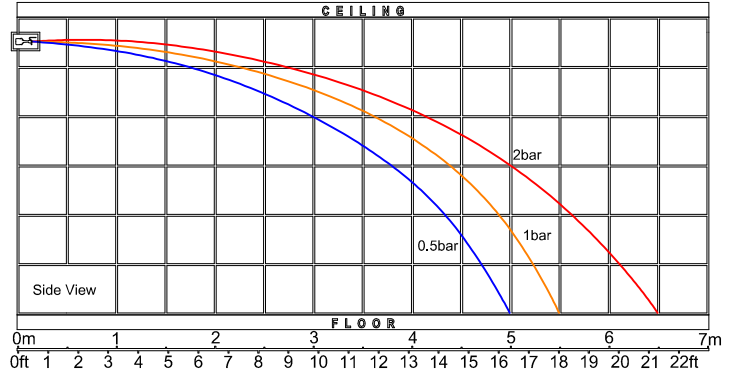
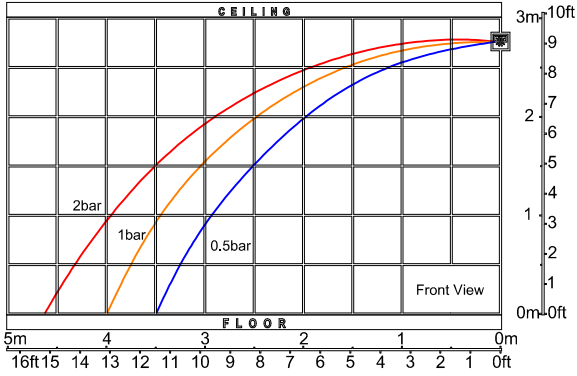

### Sprinkler Spanner



Always use appropriate sprinkler spanner for installing the sprinklers.